

DASH #	'L' DIM.
6	.375
8	.500
10	.625
12	.750
14	.875
16	1.000
20	1.250
24	1.500

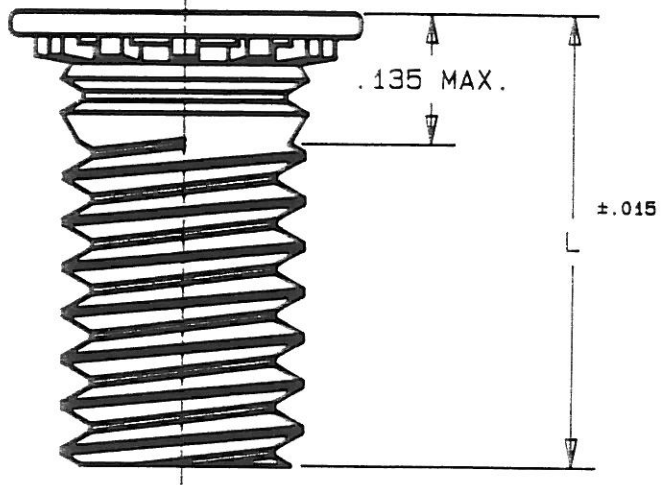

NOTICE: CONFIDENTIAL, PROPRIETARY INFORMATION THIS PRINT CONTAINS IDEAS AND INFORMATION WHICH ARE THE EXCLUSIVE PROPERTY OF PENN ENGINEERING & MANUFACTURING CORP., AND IS SUPPLIED TO RECIPIENT FOR ENGINEERING STUDY ONLY. THE RECIPIENTS MUST KEEP THESE IDEAS AND THE INFORMATION DISCLOSED HEREIN CONFIDENTIAL AND ARE EXPRESSLY PROHIBITED FROM ANY COPYING OR PUBLICATION OF THIS PRINT, EXCEPT FOR OTHERS WITHIN THEIR ORGANIZATION ON A NEED-TO-KNOW BASIS.

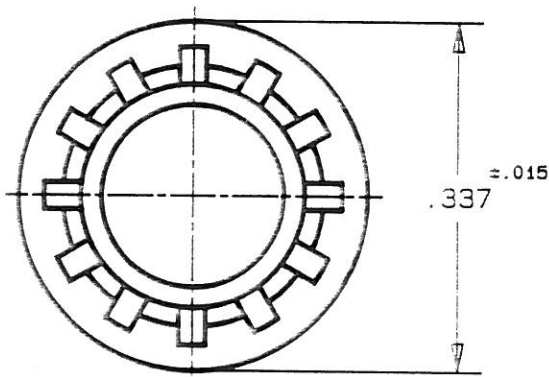

REV	DATE	ECN #

© 1988, PENN ENGINEERING & MANUFACTURING CORP.

THREAD	1/4-20 UNC-2A	MOUNTING HOLE:	.249 ^{+.003} _{-.000}				
MATERIAL	AISI 316 STAINLESS STEEL	PANEL THICKNESS:	.062 MIN.				
HEAT TREAT	NONE	MAX. PANEL HARDNESS:	HRB 70				
FINISH	PASSIVATE	MIN. ϕ TO EDGE DISTANCE:	.312				
FINISH SPEC	ASTM A380	PEM® PENN ENGINEERING & MANUFACTURING CORP. DANBORO, PENNSYLVANIA 18916					
DESC	SELF-CLINCHING FLUSH HEAD STUD						
CAD NO.	SCALE	CHK BY	DATE	BY	DATE	NO.	REV
12037	NONE	BCC	2-4-91	BCC	1-31-91	YC3-8592-L	