

SCREW ASSEMBLY BEFORE MOUNTING

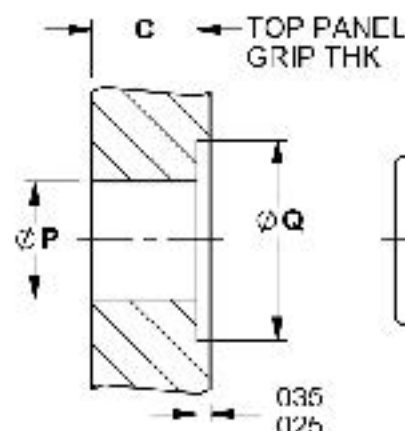

PANEL PREPARATION

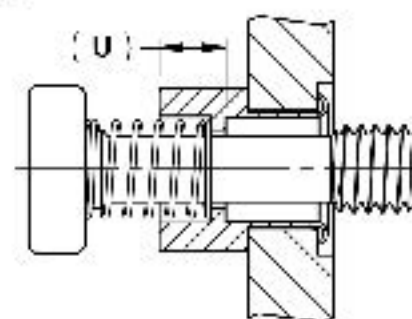

**SCREW ASSEMBLY
AFTER MOUNTING**

THREAD SIZE CODE	Ø G	I	(Z)	Ø M	Ø N ±.005	Ø P +.004 -.001	Ø Q +.020 -.000	R MAX	Ø S +.000 -.000	T ±.005	(U)	V	J	TOTAL INTERNAL FLOAT WITHIN
4	.250	.100	.220	.250	.178	.187	.281	.330	.075	1/8	.115	.060	3/32	.017-.025
6	.300	.100	.220	.300	.202	.209	.312	.330	.090		.115	.060	7/64	.023-.032
8	.300	.100	.215	.302	.215	.221	.343	.335	.117		.130	.073	1/8	.022-.032
10														.025-.034
10C	.301	.125	.200	.300	.250	.257	.375	.330	.128	191	.145	.082	9/64	.037-.046
12														.025-.035
12C	.402	.156	.210	.402	.313	.323	.437	.380	.175		.165	.104	5/32	.040-.050

**PART NUMBER
CALLOUT**

DXH7900 ()-()-()

MODEL

SERIES

LENGTH CODE	L	L1			
		4, 6	8	10, 10c	12, 12c
1	.430	.270	.275	.290	NA
2	.550	.330	.335	.350	.340
2.5	.610	.380	.395	.410	.400
3	.670	.450	.455	.470	.460
4	.730	.510	.515	.530	.520
4.5	.820	.600	.605	.620	.610
5	.920	.700	.705	.720	.710
6	1.045	.825	.830	.845	.835
6.5	1.107	.887	.892	.907	.897
7	1.170	.950	.955	.970	.960
7.5	1.232	1.012	1.017	1.032	1.022
8	1.295	1.075	1.080	1.095	1.085
8.5	1.357	1.137	1.142	1.157	1.147

NOTES UNLESS SPECIFIED OTHERWISE:

1 FOR LONGER LENGTHS "L", ADD .125 INCREMENTS PER LENGTH CODE

2 CHECK SHEET 2 FOR "I" LENGTH AVAILABILITY TABLES

MATERIAL:

STUD:
A-206 CRES STEEL PER AMS 5737,
HEAT TREAT TO 160 KSI MIN. HRC 36 MIN
SLEEVE:
304 CRES PER AMS 5639 OR AMS-QQ-S-763
SPRING:
302 CRES PER AMS 5688 OR ASTM A 313
OR ASTM-A-580 COND B

FINISH:

ALL COMPONENTS PASSIVATE PER AMS2700

INSTALLATION TOOLS: () INDICATES THREAD SIZE CODE

ARBOR PRESS TOOL HW7800-(), NOSE PIECE HW7513-(),
PULLER FR HP7523-(), HANDIF ASSEMBLY TA7533

COMPLETE HANDIF TOOL ASSEMBLY:
H8603-() INCLUDES NOSE PIECE, PULLER & HANDLE

THREAD SIZE CODE	THREAD SIZE PER ASME B1.1	LEAD	C		K ±.035
			GRIP CODE	(TOP PANEL GRIP THICKNESS)	
4	.112-40 UNC-3A	SINGLE	A	.031-.062	.085
6	.138-32 UNC-3A		D	.063-.125	.147
8	.164-32 UNC-3A		C	.126-.187	.210
10	.190-32 UNF-3A		I	.188-.250	.272
12	.250-28 UNF-3A		E	.251-.312	.335
10C	.190-24 UNC-3A	SINGLE (COARSE)	F	.313-.275	.397
12C	.250-20 UNC-3A				

N PER DCN 13112, REVISED SHEET 1 FORMAT

TOLERANCE UNLESS
OTHERWISE NOTED:
X = ±.05
XX = ±.02
XXX = ±.015
ANGLES ±0.5°

DESIGNED BY J. SCHILCOFF

APPROVED BY SIGNATURE ON FILE

DATE: 6/23/2005
REV: 1: 6/19/2005
PAGE: 1 OF 2

**CAPTIVE SCREW, PAN HEAD, HEX RECESS,
INTERNAL FLOAT, SPRING-LOADED**

**DXH7900
S-2599**

DIMENSIONS IN INCHES



AVAILABILITY TABLE

RETRACTABILITY TABLE

GRIP CODE	SIZE 4, 6							
	1	2	2.5	3	4	4.5	5	6 THRU 8.5
A	.145							
B		.143						
C			.141					
D				.139				
E					.137			
F						.163	.135	

GRIP CODE	SIZE 4						
	1	2	2.5	3	4	4.5 THRU 8.5	
A	O	.017	.017	.017	.017	.017	.017
B		O	O	O	O	O	O
C			O	O	O	O	O
D				O	O	O	O
E					O	O	O
F						O	O

GRIP CODE	SIZE 8							
	1	2	2.5	3	4	4.5	5	6 THRU 8.5
A	.150							
B		.148						
C			.146					
D				.144				
E					.142			
F						.168	.140	

GRIP CODE	SIZE 6						
	1	2	2.5	3	4	4.5 THRU 8.5	
A	O	.033	.033	.033	.033	.033	.033
B		O	O	O	O	O	O
C			O	O	O	O	O
D				O	O	O	O
E					O	O	O
F						O	O

GRIP CODE	SIZE 10, 10C							
	1	2	2.5	3	4	4.5	5	6 THRU 8.5
A	.165							
B		.163						
C			.161					
D				.159				
E					.157			
F						.183	.155	

GRIP CODE	SIZE 8						
	1	2	2.5	3	4	4.5 THRU 8.5	
A	O	.053	.053	.053	.053	.053	.053
B		O	.021	.021	.021	.021	.021
C			O	O	O	O	O
D				O	O	O	O
E					O	O	O
F						O	O

GRIP CODE	SIZE 12, 12C							
	1	2	2.5	3	4	4.5	5	6 THRU 8.5
A								
B			.182					
C				.190				
D					.188			
E								
F								

GRIP CODE	SIZE 10, 10C						
	1	2	2.5	3	4	4.5 THRU 8.5	
A	.049	.083	.083	.083	.083	.083	.083
B		.015	.015	.015	.015	.015	.015
C			O	O	O	O	O
D				O	O	O	O
E					O	O	O
F						O	O

GRIP CODE	SIZE 12, 12C						
	1	2	2.5	3	4	4.5 THRU 8.5	
A		.089	.089	.089	.089	.089	.089
B			.054	.060	.060	.060	.060
C			O	O	O	O	O
D				O	O	O	O
E					O	O	O
F						O	O

■ NOT AVAILABLE
□ INDICATES FULL THREAD LENGTH (T) UNLESS OTHERWISE SPECIFIED

■ NOT AVAILABLE
○ FULLY RETRACTABLE (STUD WILL NOT PROTRUDE BELOW TOP PANEL IN RETRACTED POSITION)

* IF NO C-BORE USED, ADD .030 TO EACH ENTRY IN RETRACTABILITY TABLES



N	PER DCN 13112, REVISED SHEET FORMAT		TOLERANCE UNLESS OTHERWISE NOTED: X = ±.05 XX = ±.02 XXX = ±.015 ANGLES ±0.5° DIMENSIONS IN INCHES	DESIGNED BY J. SCHILCOFFM
	CAPTIVE SCREW, PAN HEAD, HEX RECESS, INTERNAL FLOAT, SPRING-LOADED			DRAWN BY SIGNATURE ON FILE
	DATE: 6/20/2005	REV: 1: 6/19/2005		FACE: 2 OF 2

This drawing/documentation is controlled by either the Department of State, International Traffic in Arms Regulations or the Department of Commerce, Export Administration Regulations and may require an export license prior to being transferred to a foreign nation (inside or outside of the United States). LAA/CCN LAA/98. These commodities, technology or software are exported from the United States in accordance with the Export Administration Regulations. Diversion contrary to U.S. law prohibited.

THIS DRAWING, SPECIFICATION, STANDARD OR REQUIREMENT IS THE PROPERTY OF ALCOA AND IS NOT TO BE REPRODUCED OR TRANSMITTED IN ANY FORM OR BY ANY MEANS, ELECTRONIC OR MECHANICAL, INCLUDING PHOTOCOPYING, RECORDING, OR BY ANY INFORMATION STORAGE AND RETRIEVAL SYSTEM, WITHOUT PERMISSION IN WRITING FROM ALCOA.