

SCREW ASSEMBLY BEFORE MOUNTING

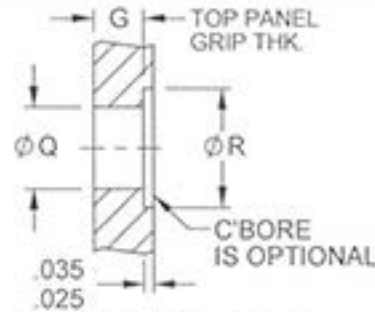

PANEL PREPARATION

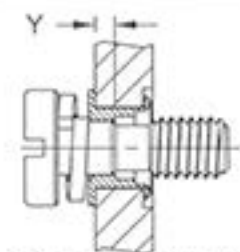

SCREW ASSEMBLY  
AFTER MOUNTING

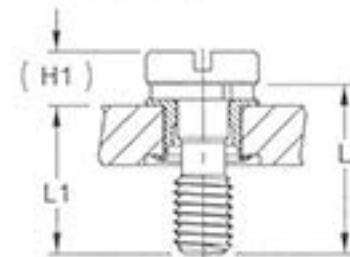
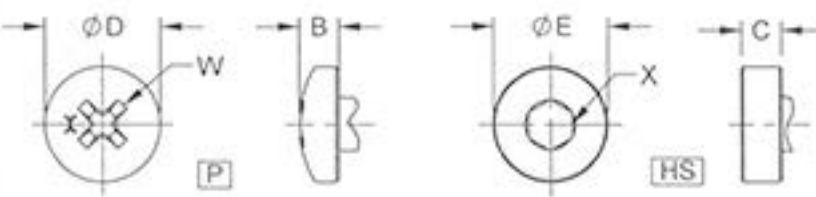

SCREW ASSEMBLY  
AFTER MOUNTING

THREAD SIZE CODE	A	B	C	ØD	ØE	(H1)			ØM ±.005	ØN ±.010	ØQ +.004 -.001	ØR +.020 -.000	T	V	W	X
						SLOT	P	HS								
4, 4F	.063	.075	.110	.212	.180	.108	.120	.155	.178	.219	.187	.281		.040	4	3/32
6, 6F	.077	.092	.135	.263	.222	.128	.143	.186	.202	.265	.209	.312		.044	6	7/64
8, 8F	.090	.110	.161	.314	.266	.150	.170	.221	.215	.314	.221	.343		.049	8	9/64
10, 10C, 10F	.104	.127	.187	.365	.307	.171	.194	.254	.250	.365	.257	.375		.055	10	5/32
12, 12C, 12F	.137	.168	.247	.482	.370	.219	.250	.329	.313	.492	.323	.437		.062	1/4	3/16

PART NUMBER CALLOUT

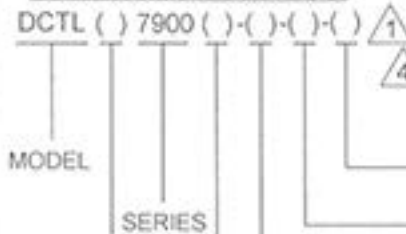

LENGTH CODE	L ±.020	L1				
		4	6	8	10	12
1	.347	.302	.296	NA		
2	.472	.427	.421	.412	.405	.390
3	.597	.552	.546	.537	.530	.515
4	.722	.677	.671	.662	.655	.640
5	.847	.802	.796	.787	.780	.765
6	.972	.927	.921	.912	.905	.890

GRP CODE	G (TOP PANEL GRP THK)	K ±.005	Y ±.005
B	.063-.125	.147	
C	.126-.187	.210	
D	.188-.250	.272	.062
E	.251-.312	.335	
F	.313-.375	.397	

THREAD SIZE CODE	THREAD SIZE	LEAD	THREAD SIZE CODE	THREAD SIZE	LEAD
4	.112-40 UNC-2A	SINGLE	4F	.112-40 UNC-2A	DOUBLE
6	.138-32 UNC-2A		6F	.138-32 UNC-2A	
8	.164-32 UNC-2A		8F	.164-32 UNC-2A	QUAD
10	.190-32 UNF-2A		10F	.190-32 UNF-2A	
12	.250-28 UNF-2A	SINGLE (COARSE)	12F	.250-28 UNF-2A	
10C	.190-24 UNC-2A				
12C	.250-20 UNC-2A				

CODE	STUD MATERIAL/FINISH
NONE	A-286 (SIZE 4 & 6)PASSIVATE
	302 (SIZE 8, 10 & 12)PASSIVATE
A	A-286 (SIZE 8, 10 & 12)PASSIVATE
B	A-286 (SIZE 8, 10 & 12)BLACK OXIDE
E	A-286 (SIZE 4 & 6)BLACK OXIDE
	302 (SIZE 8, 10 & 12)BLACK OXIDE

RECESS CODE	DRIVING RECESS AND SPECIFICATION
NONE	SLOT RECESS PER ANSIB18.6.3
HS	SOCKET HEAD HEX RECESS PER ANSIB18.3
P	CROSS RECESS PER NASM 9006

DIMENSIONS IN INCHES

TOLERANCE UNLESS  
OTHERWISE NOTED:  
X = ±.05  
XX = ±.02  
XXX = ±.015  
ANGLES ±0.5°

DRAWN BY J. SCHLOHM  
CHECKED BY J. HEN  
CAGE CODE  
0HDW7

R PER DCN 9351, CHANGED CODE TABLE SHEET 1,  
REVISED MATERIAL DESIGNATIONS, SHEET 2

ISSUED	1/31/2005
REVISED	11/12/2010
PAGE	1 OF 2

CAPTIVE SCREW, OPTIONAL RECESS,  
LOCKING, THREAD LENGTH CONTROLLED,  
A-286/302 STUD MATERIAL OPTIONS

DCTL ( ) 7900  
S-2141

THIS DRAWING, THE STRUCTURAL DESIGN DISCLOSED THEREIN AND THE TECHNICAL DATA AND ENGINEERING SERVICE REPRESENTED THEREBY ARE THE EXCLUSIVE PROPERTY OF HUCK INTERNATIONAL, INC.



THREAD LENGTH AVAILABILITY TABLE																		
GRIP CODE	4, 4F, 6, 6F						8, 8F, 10, 10C, 10F						12, 12C, 12F					
	1	2	3	4	5	6	2	3	4	5	6	2	3	4	5	6		
A	.140						.230					.198						
B							.168			.250		.136	.261			.280		
C		.140		.203				.230					.198					
D								.168					.136	.261				
E			.140						.230					.198				
F									.168					.136	.261			

ASSEMBLIES NOT AVAILABLE

**MATERIAL:**

STUD:  
A286 CRES PER AMS 5732, AMS 5737, HEAT TREAT TO 160 KSI MIN UTS  
OR  
302 CRES PER ASTM-A-493, AMS 5636  
SLEEVE: ALL SIZES: 304 CRES PER AMS 5639 AND AMS-QQ-S-763  
LOCK WASHER: 300 SERIES CRES PER ASME B18.21.1

**FINISH:**

PASSIVATE PER AMS2700 AND AMS-QQ-P-35.  
BLACK OXIDE PER MIL-C-13924, CLASS 3 (A286)  
BLACK OXIDE PER MIL-C-13924, CLASS 4 (300 SERIES)

**NOTES:**

- 1) LETTERS AT THE END OF PART NUMBER DESIGNATE SPECIAL ASSEMBLIES:  
DL - ASSEMBLIES WITH DRI LUBE THREADS PER MIL-PRF-46010  
PL - ASSEMBLIES WITH PATCH LOCK PER MIL-DTL-18240
- 2) -2A THREADS PER ASME B1.1.
- 3) NO CODE REQUIRED FOR SLOTTED RECESS HEADS.
- 4) FOR LONGER LENGTHS "L", ADD .125 INCREMENTS PER LENGTH CODE.
- 5) SEE APPROPRIATE THREAD LENGTH AVAILABILITY TABLE FOR "T" DIMENSION.

INSTALLATION TOOLS: ( ) INDICATES THREAD SIZE CODE

ARBOR PRESS TOOL HW7600-( )

HAND TOOL: H8603-( ), INCLUDES  
NOSE PIECE HN7513-( ), PULLER HP7523-( ), AND  
HANDLE ASSEMBLY TA7533

DIMENSIONS IN INCHES

**R**

PER DCN 9351, CHANGED CODE TABLE SHEET 1,  
REVISED MATERIAL DESIGNATIONS, SHEET 2

TOLERANCE UNLESS OTHERWISE NOTED:  
X = ±.05  
XX = ±.02  
XXX = ±.015  
ANGLES ±0.5°

DRAWN BY: J. SCHLOBOHM  
CHECKED BY: J. HEIN

ISSUED: 1/31/2005  
REVISED: 11/12/10  
PAGE: 2 of 2

CAPTIVE SCREW, OPTIONAL RECESS,  
LOCKING, THREAD LENGTH CONTROLLED,  
A-286/302 STUD MATERIAL OPTIONS

DCTL( )7900  
S-2141

THIS DRAWING, THE STRUCTURAL DESIGN DISCLOSED THEREIN AND THE TECHNICAL DATA AND ENGINEERING SERVICE REPRESENTED THEREBY ARE THE EXCLUSIVE PROPERTY OF TRUCK INTERNATIONAL, INC.

R